

Material
 Pin header: Brass, Tin plated
 Housing: PBT, UL 94 V-0

Electrical
 Rated voltage: 300V
 Rated current: 8A
 Contact Resistance: 20 m Ω
 Insulation resistance: 500MΩ/DC500V
 Withstand voltage: AC2000V / 1 min

Mechanical
 Temp. Range: -40 °C ~ +105 °C
 Soldering: 250 °C 5Sec. Max.

Order Information

L-KLS2-333J-3.50-XXP-3 XX

RoHS
 Terminal Block
 Pitch
 No.: of Pole

Product Code:00~99
 Color: 3- Black

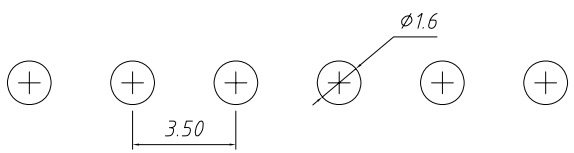

PCB LAYOUT

GENERAL TOLERANCE		ANGLE TOLERANCE		PROJECTION	Description: Screw CONN TERM BLOCK 3.50MM KLS P/N: KLS2-333J-3.50-XXP-3
X. ±0.60		X. ±5°		UNITS	
.X ±0.38		.X ±3°		mm	
.XX ±0.25		.XX ±2°		SHEET SIZE	A4
Draw by: Date				2015-09-01	
Check by: Date				2015-09-15	
SCALE		SHEET		OF	

KLS ELECTRONIC CO., LTD.